



FOR LEASE
Rooftop for Antennas

Cherry Lane Shopping Centre, Penticton BC



DESCRIPTION

Latitude: 48.4730

Longitude: 119.5766

- Central location on Main Street
- Clear view-lines.
- 100,000 sq. ft. rooftop
- Serviced and easy access
- Elevation 1,224 feet.
- Population: 33,078
- V2A Postal Count: 18,948





2111 Main St
Penticton V2A 6W6

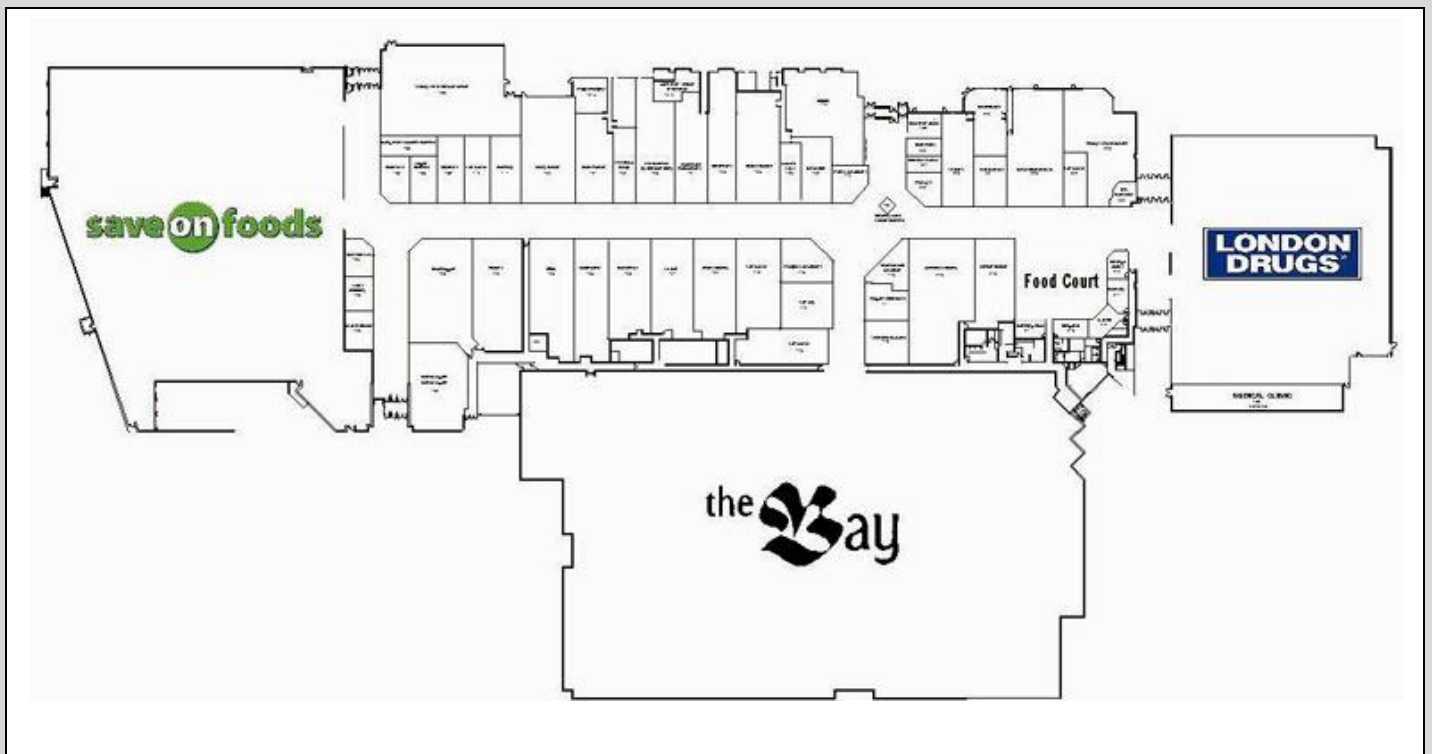

Allodium Realty Advisors, 459-409 Granville Street, Vancouver BC Canada V6C 1T2 604-340-2676 sfitzpatrick@alodium.ca alodium.ca

The information contained herein has been gathered from sources deemed to be reliable, but is not warranted as such and does not form any part of any future contract. This offering may be altered or withdrawn without notice at anytime.